

Visita Papal Lisboa 2010

# Conceito

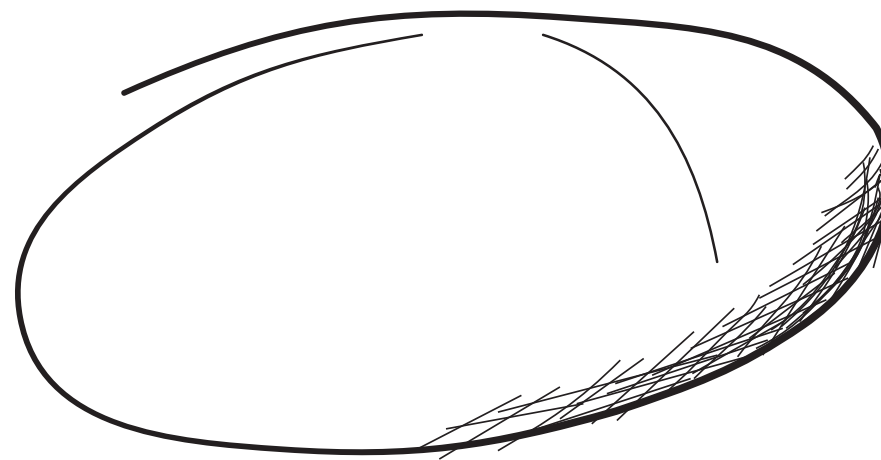



Tejo  
seixo rolado

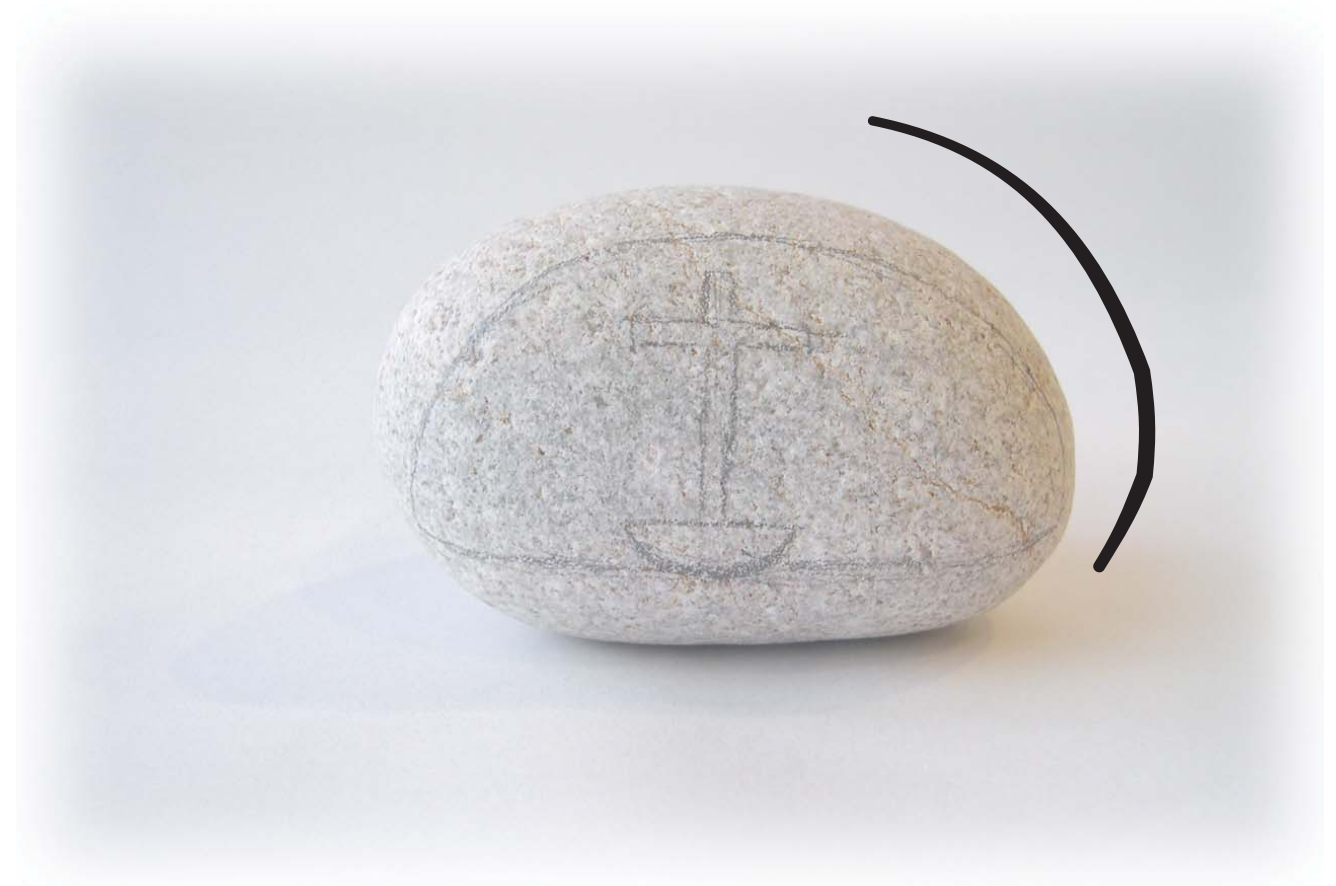

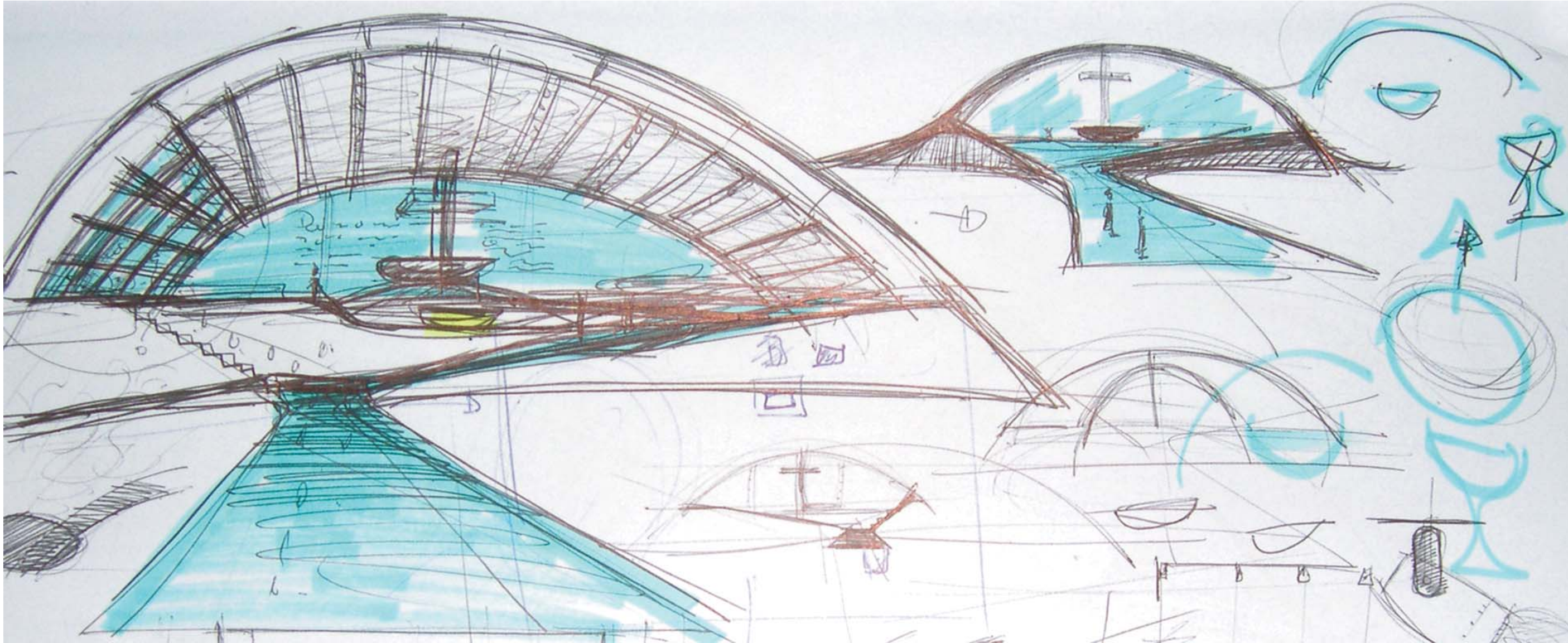

3D





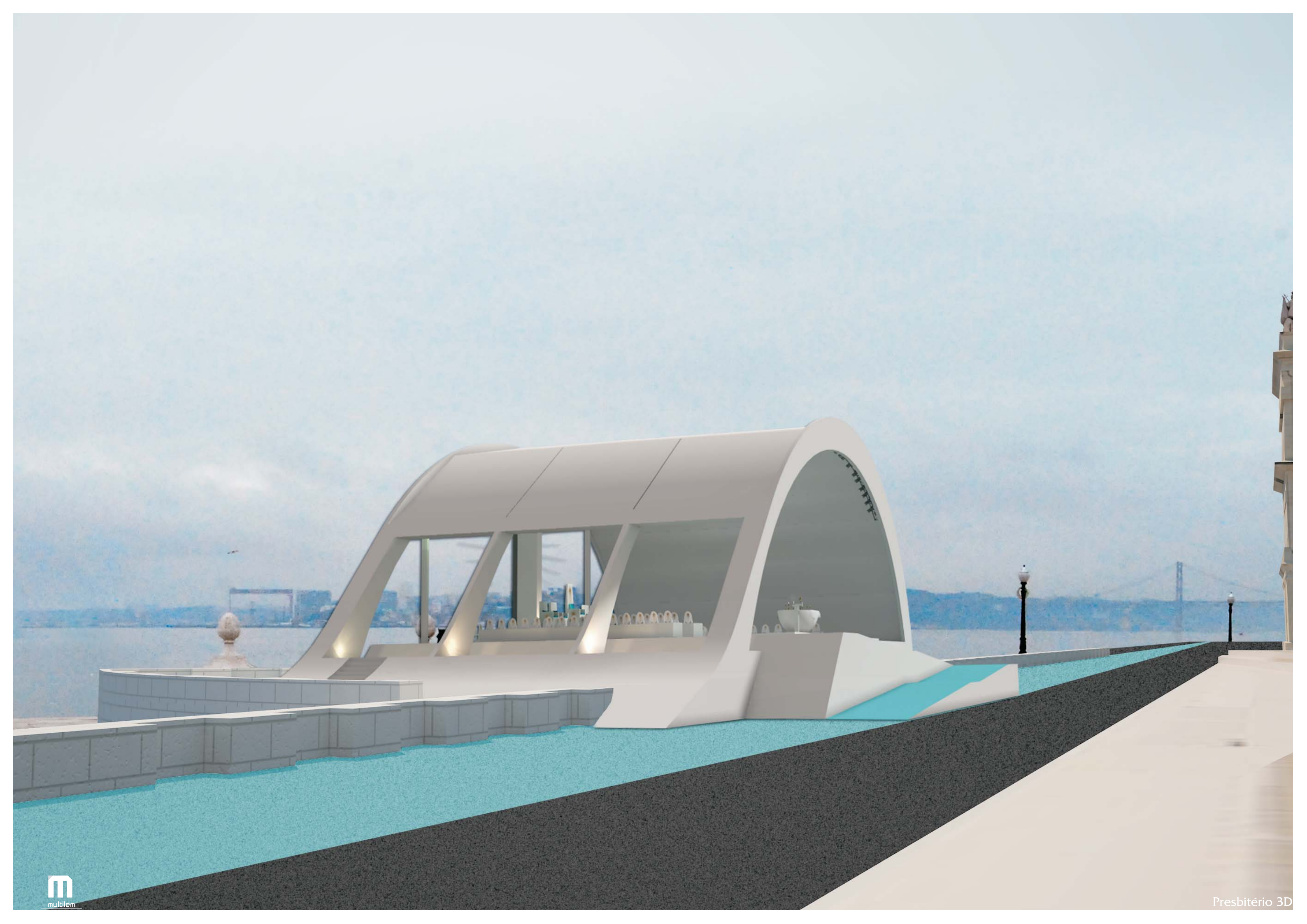



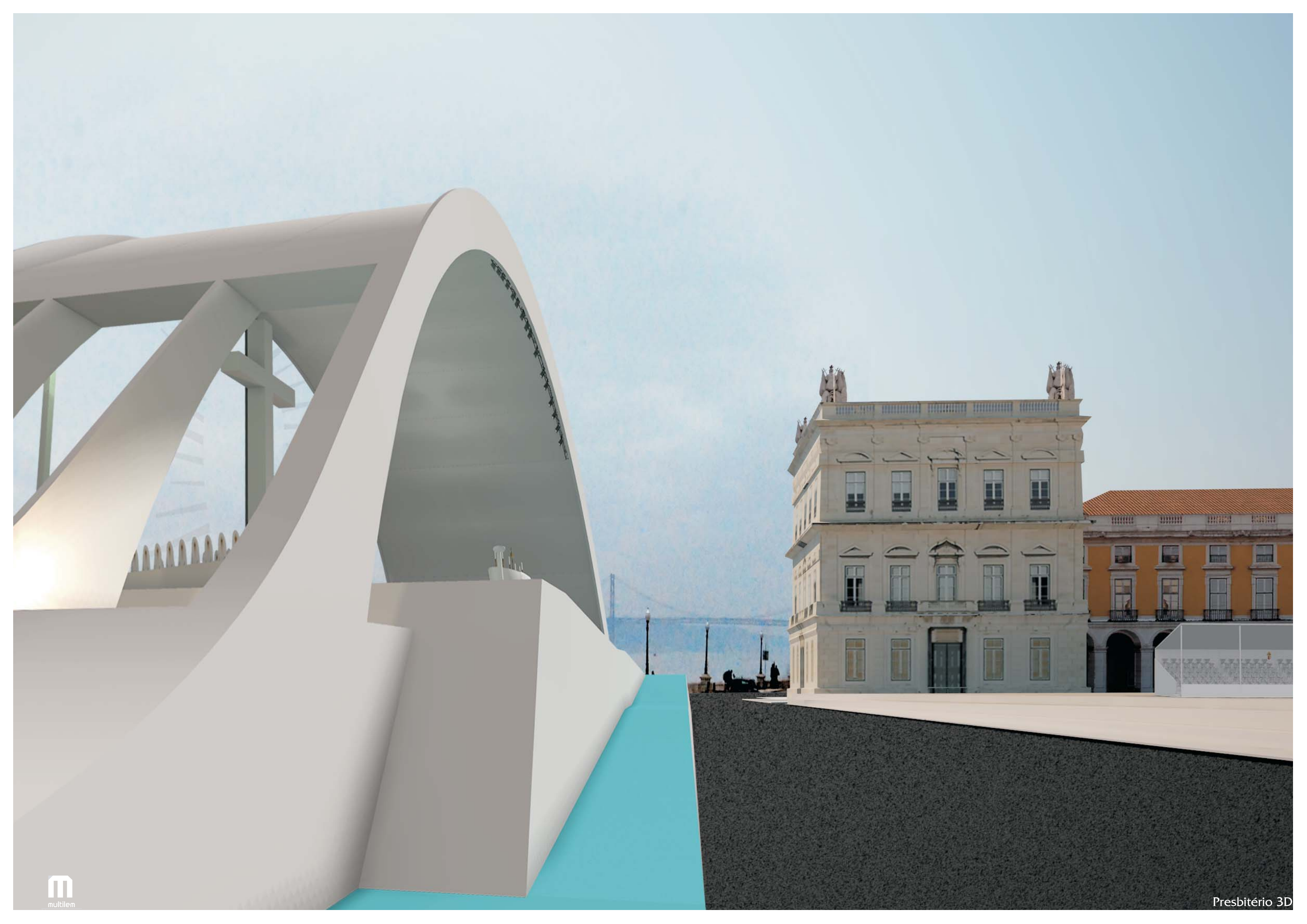

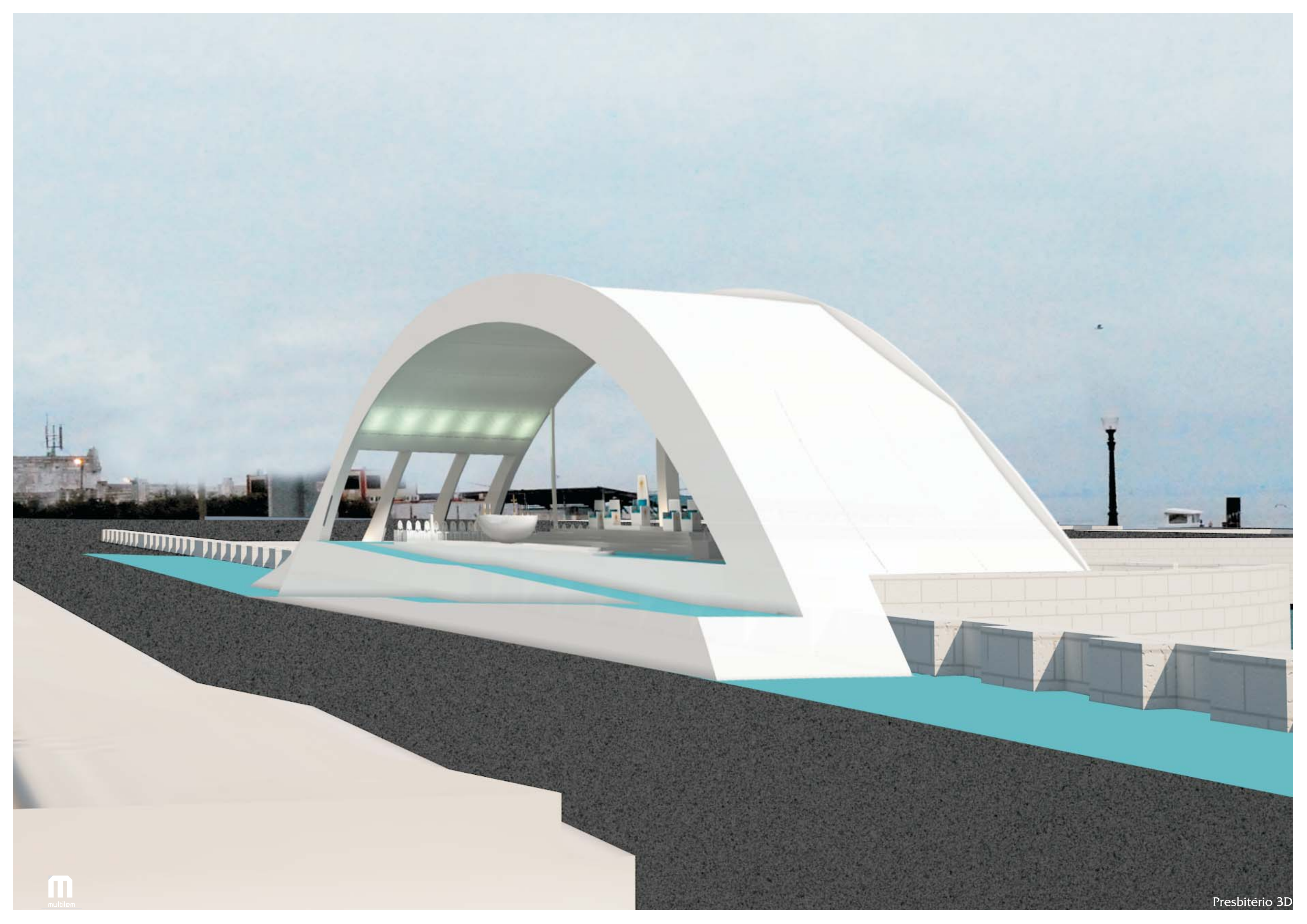

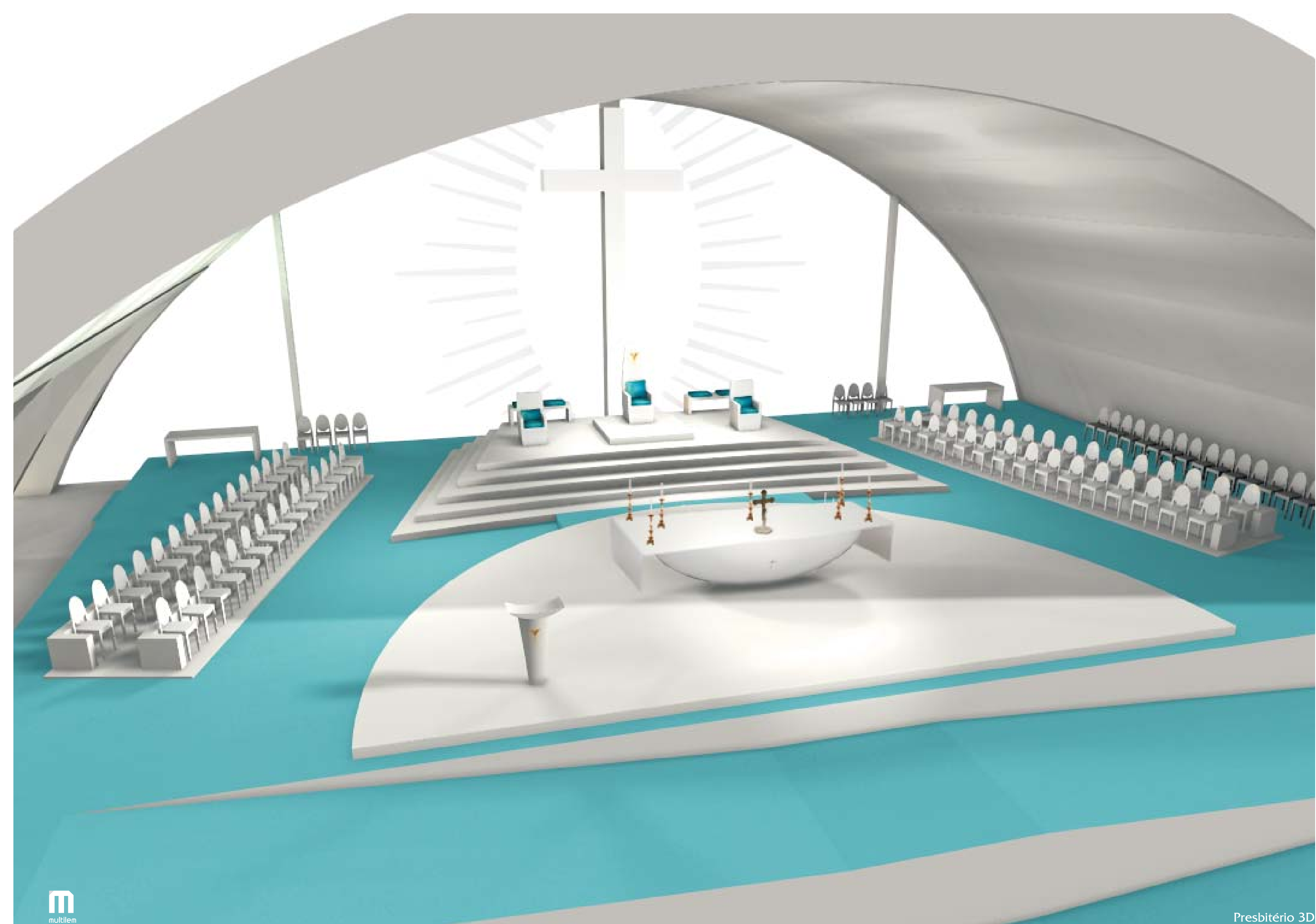

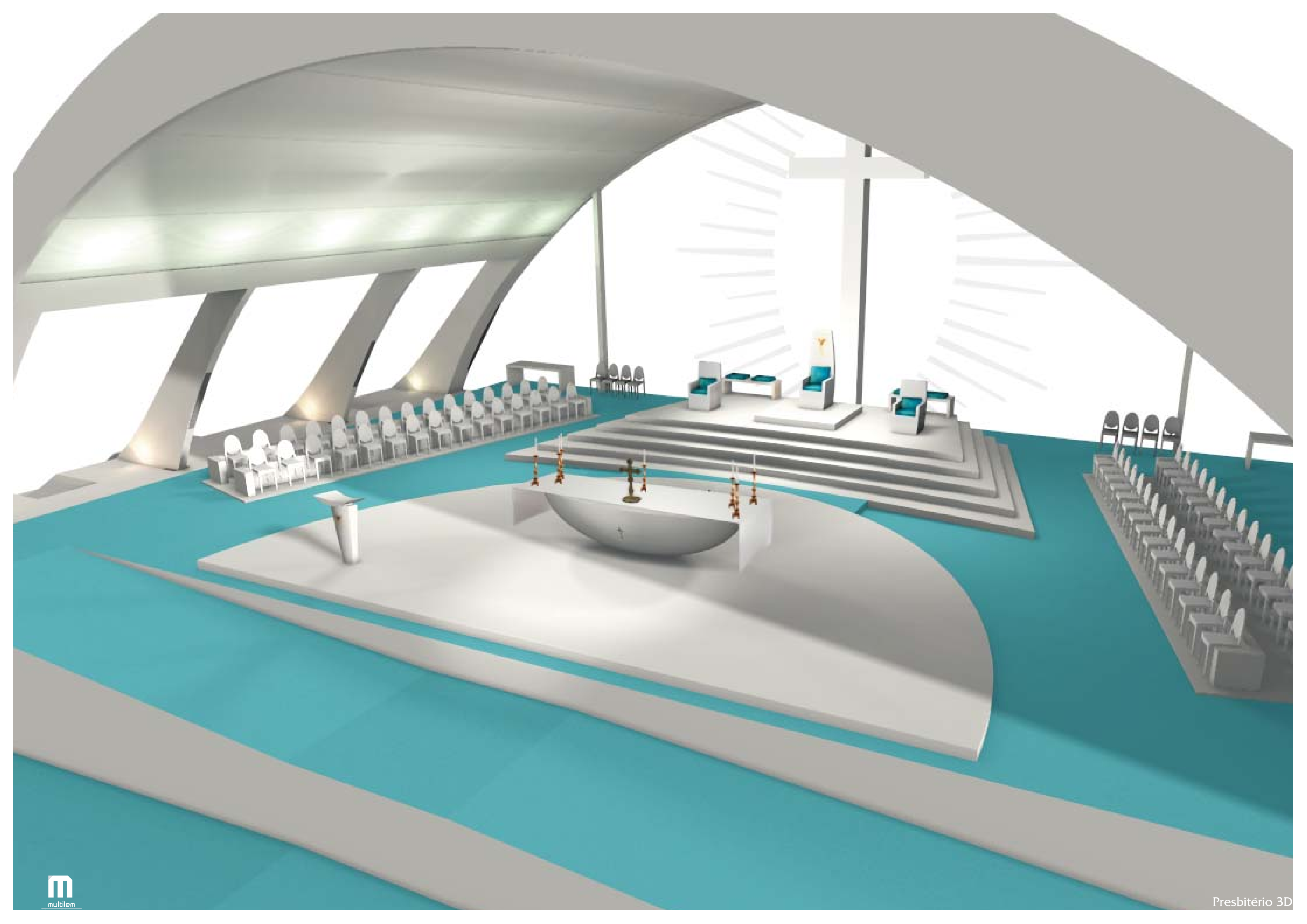

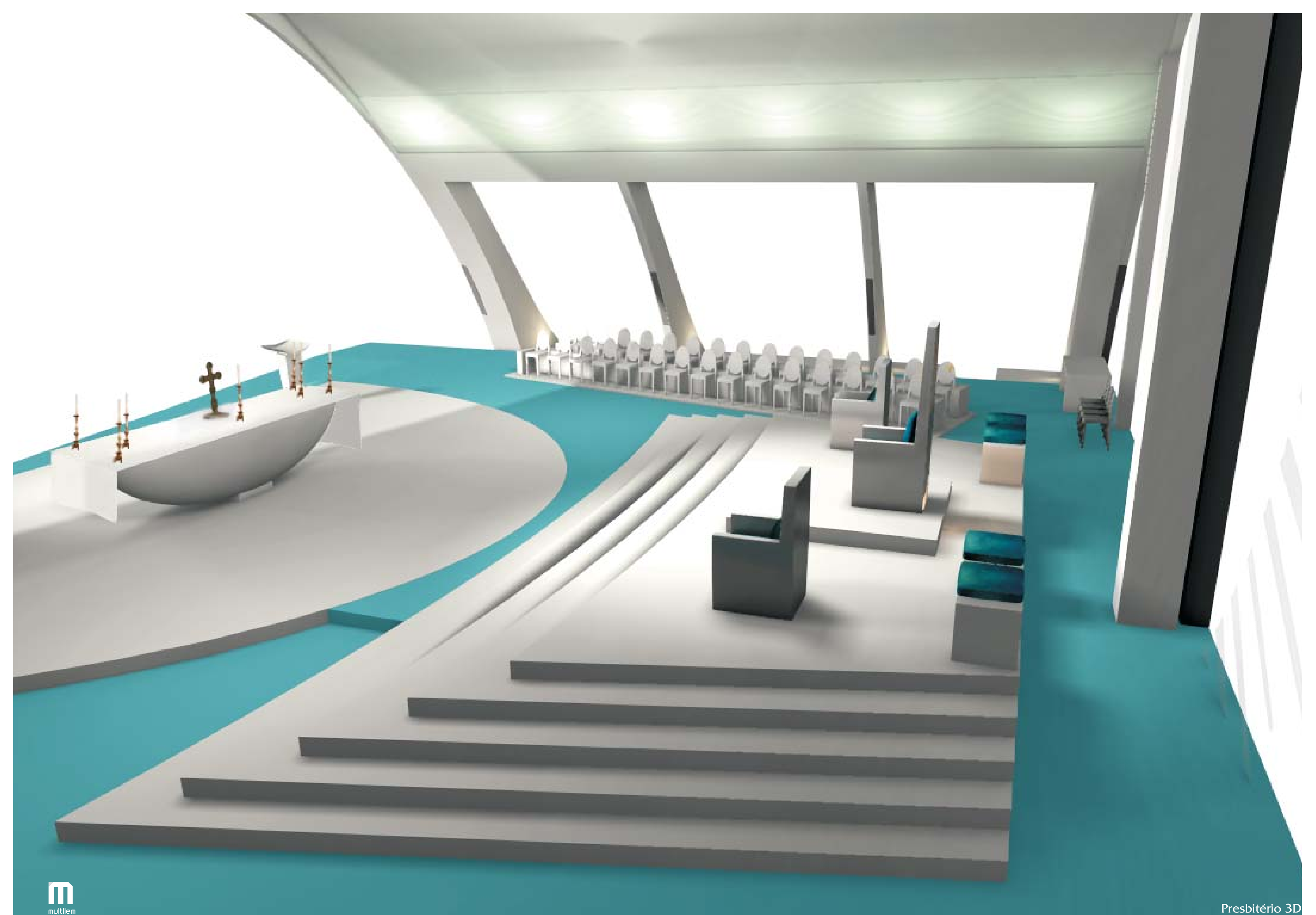

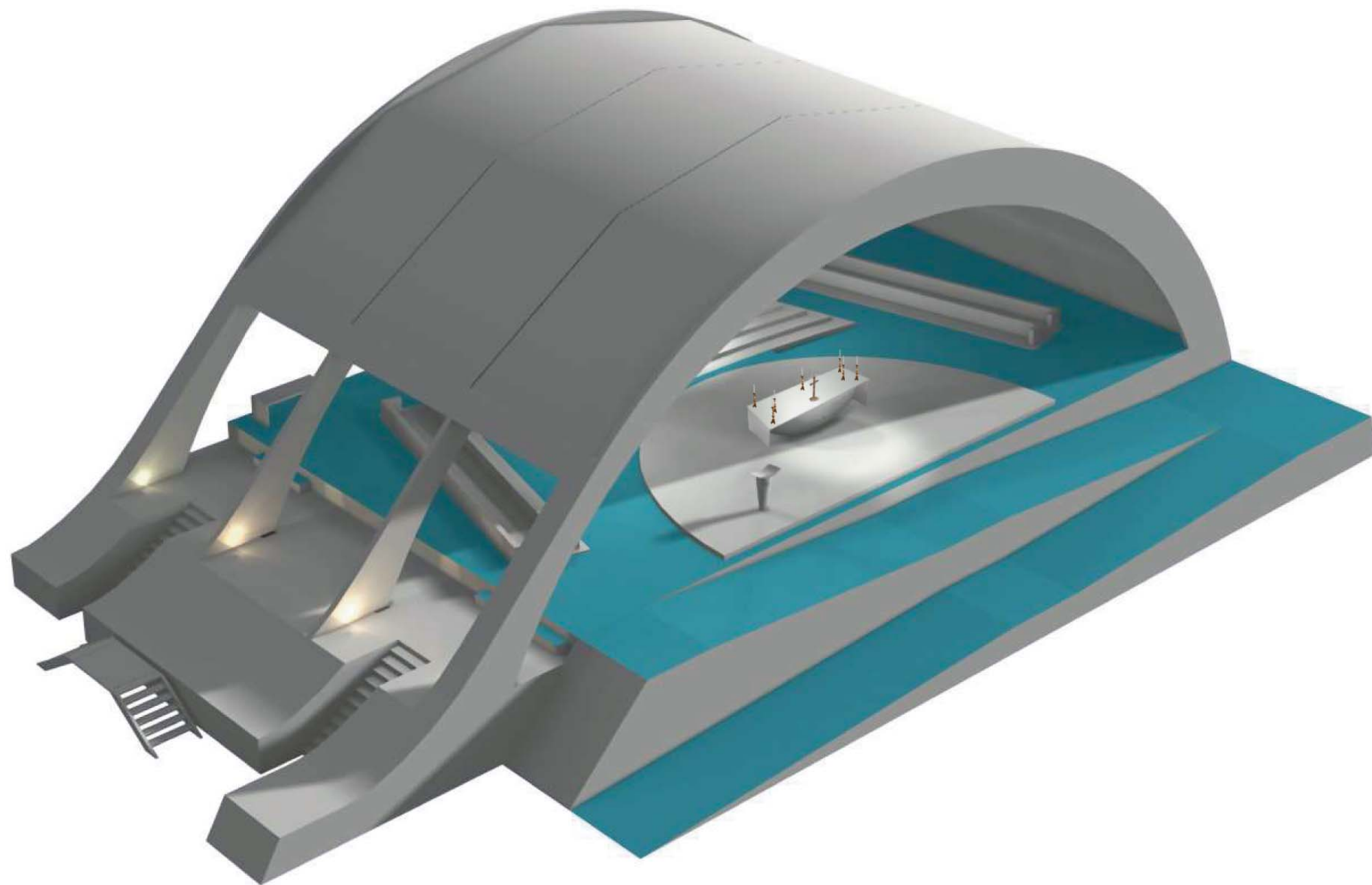

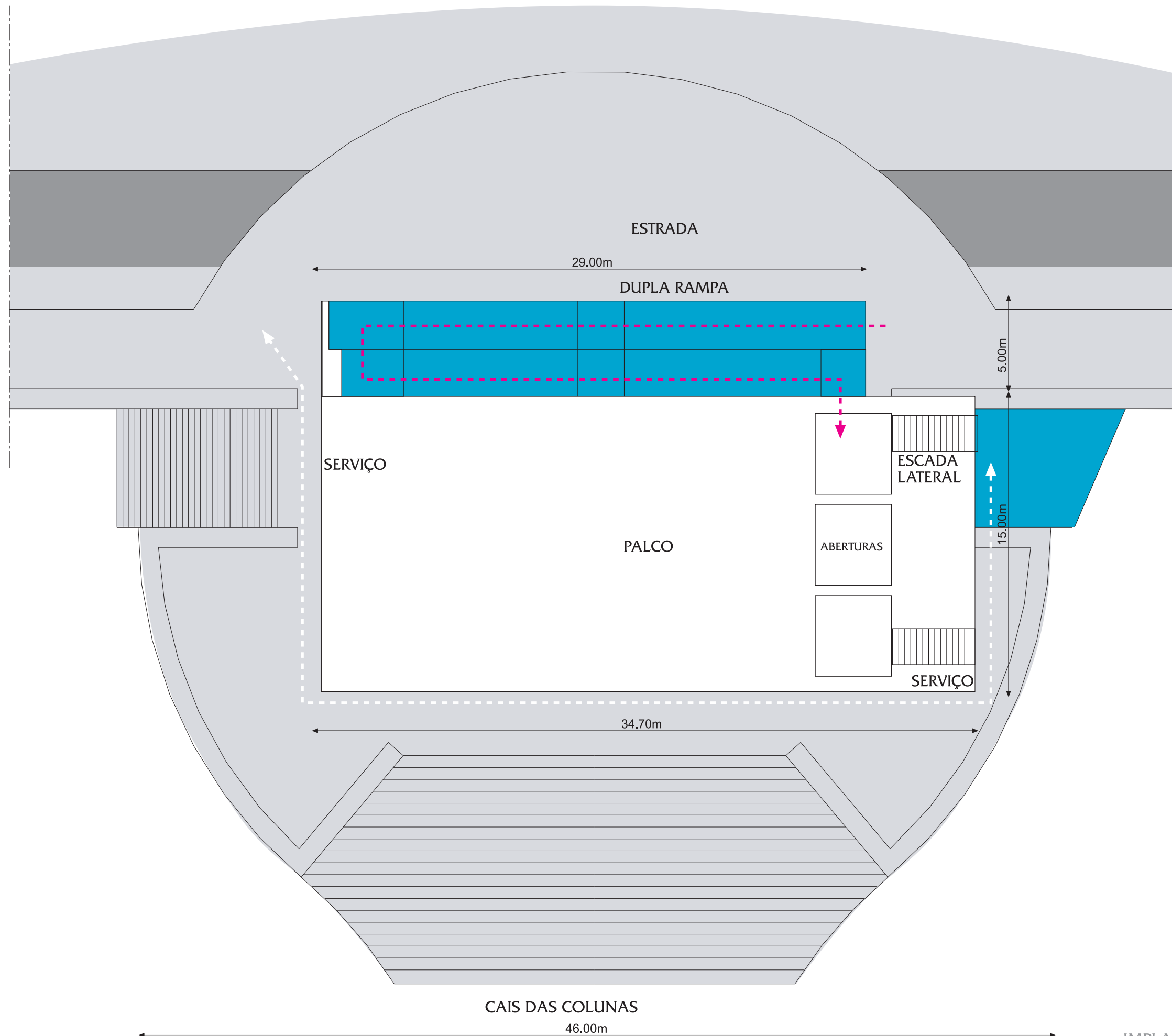

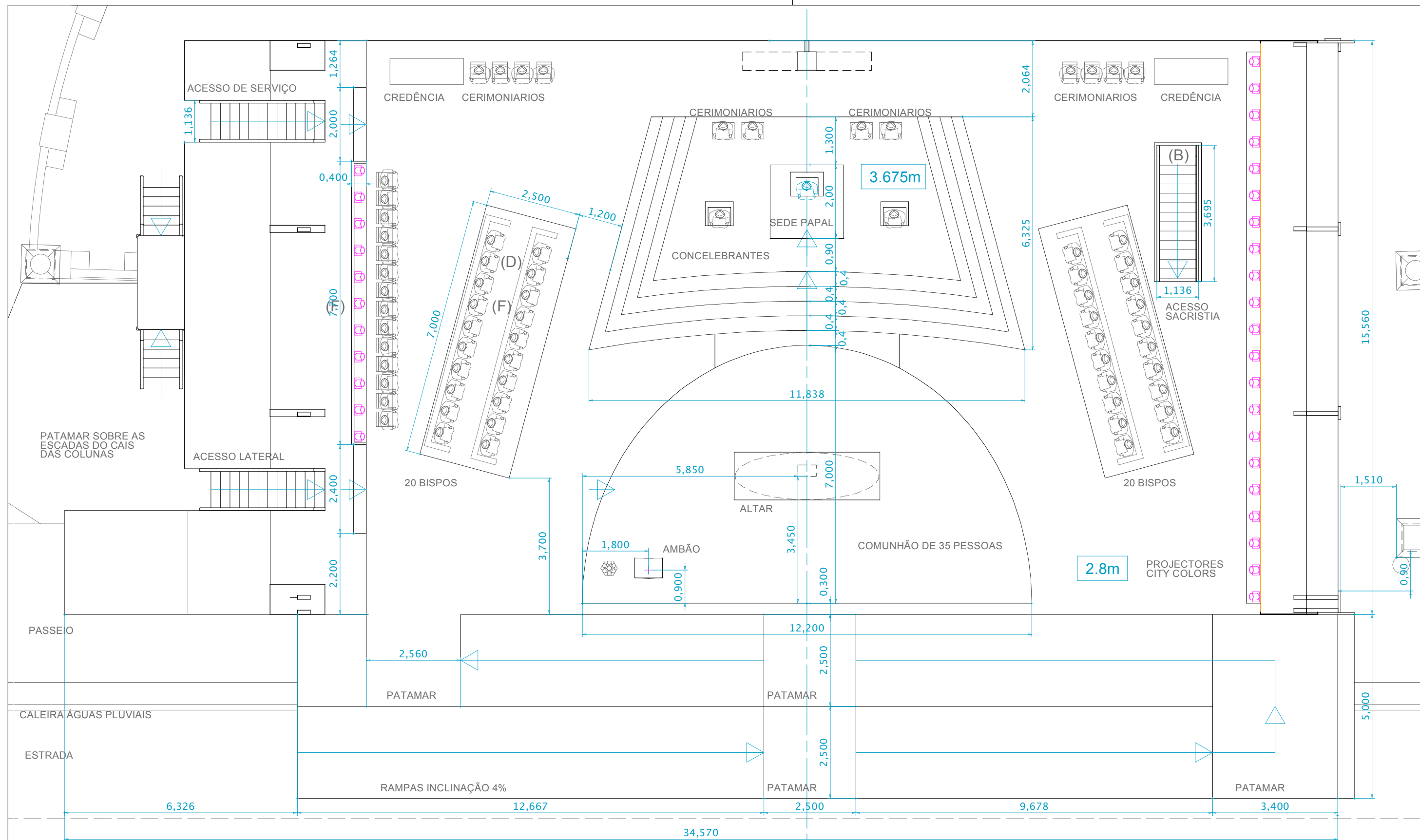

OBRA : Missa Campal Terreiro do Paço  
 REQUERENTE : Multitem  
 FASE : Licenciamento Arquitectura

03

ESCALA : 1/100  
 DESIGNAÇÃO : Planta Piso 1

DESENHO : JORGE ASSIS  
 DATA : 19.04.2010





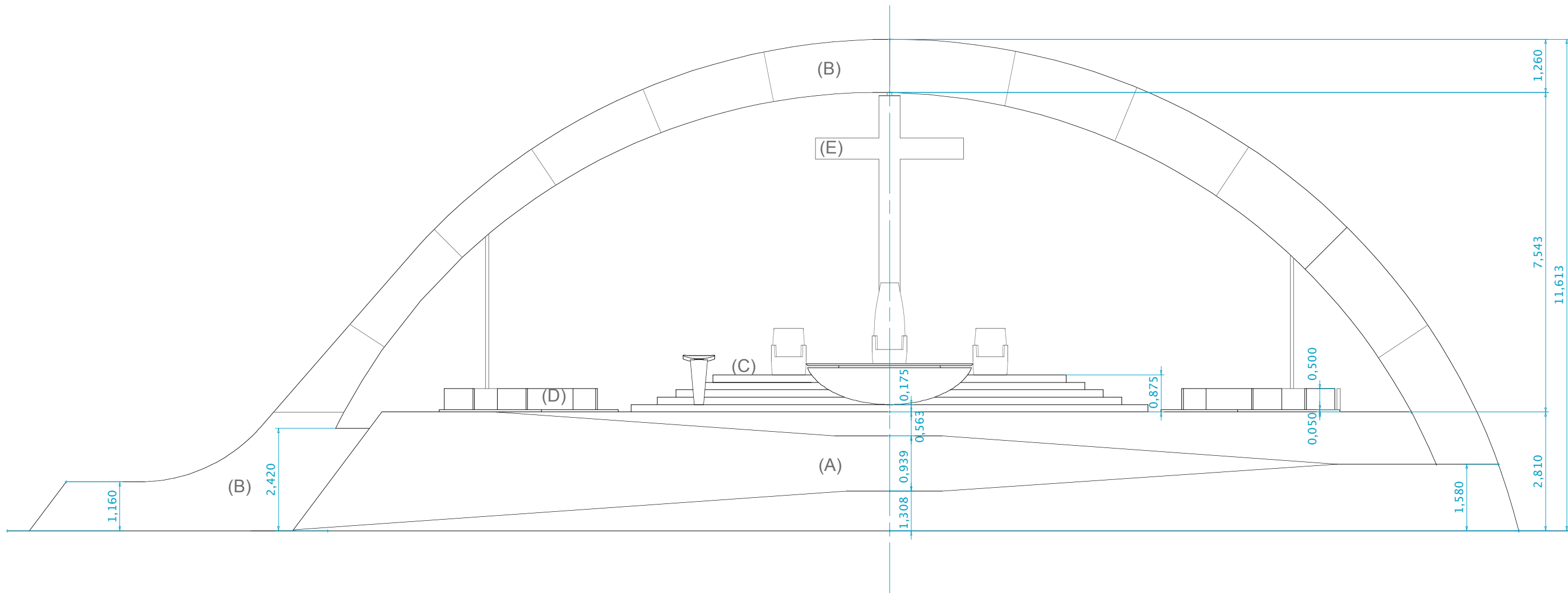

LEGENDA

- A- RAMPA. TOPOS PINTADOS DE BRANCO RAL 9003
- B- REVESTIMENTO EM CHAPA METÁLICA LACADA DE BRANCO
- C- ESTRADO EM MDF COM TOPOS LACADOS DE BRANCO RAL 9003
- D- MURETOS EM MDF PINTADO DE BRANCO RAL 9003
- E- CRUZ EXECUTADA EM CHAPA METÁLICA LACADA DE BRANCO

OBRA : Missa Campal Terreiro do Paço  
 REQUERENTE : Multiem  
 FASE : Licenciamento Arquitectura

04

ESCALA : 1/100  
 DESIGNAÇÃO : Alçado Frontal

DESENHO : JORGE ASSIS  
 DATA : 19.04.2010



# Equipamento





No equipamento estará presente o símbolo do espírito santo envolvido pelo esplendor





400X125X090cm





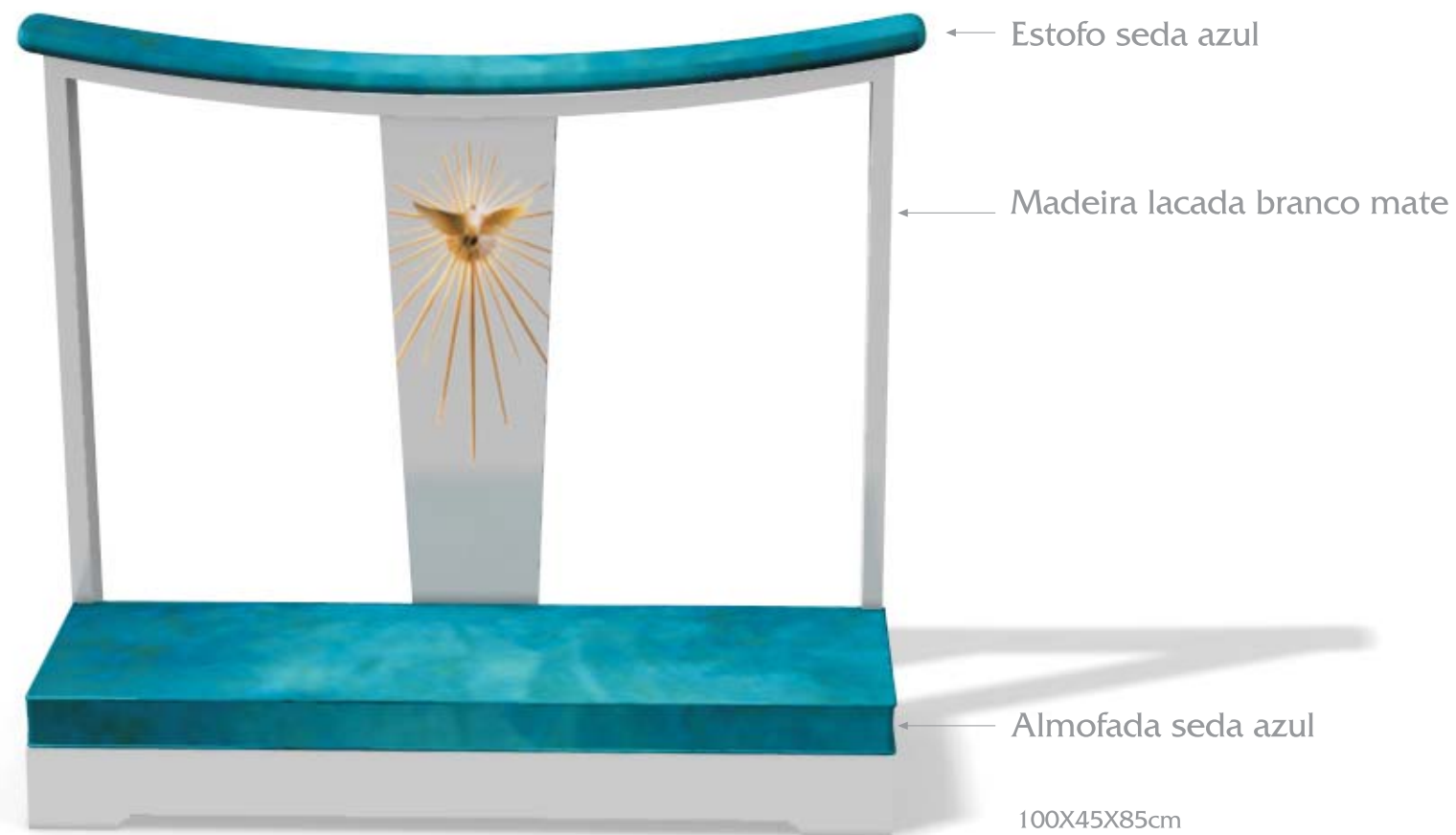

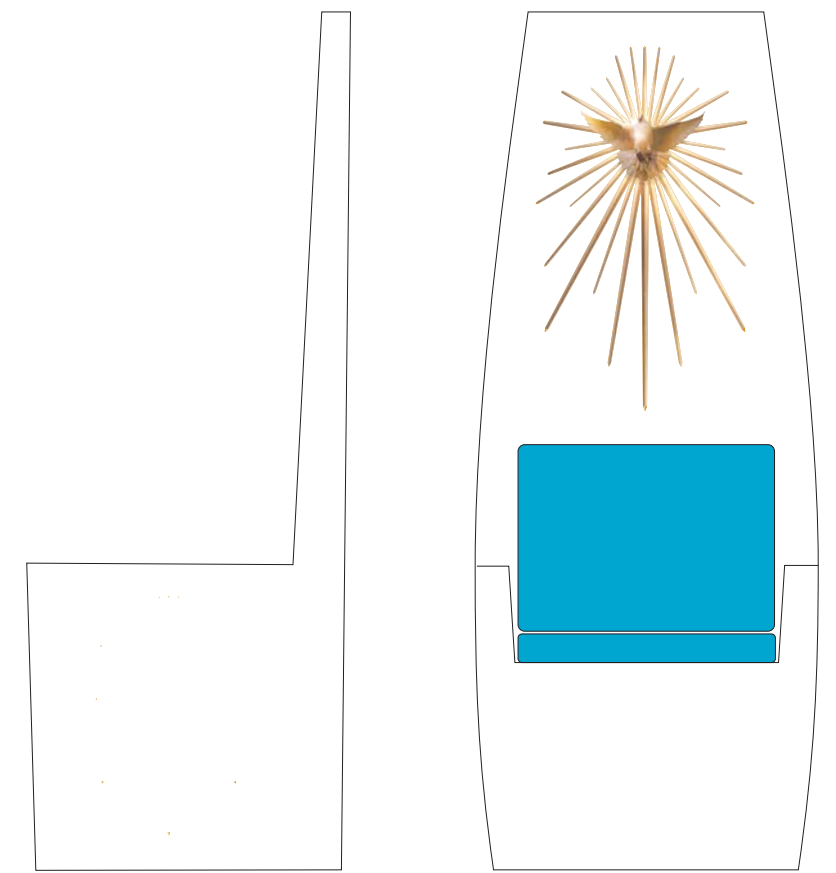

82X67X200cm



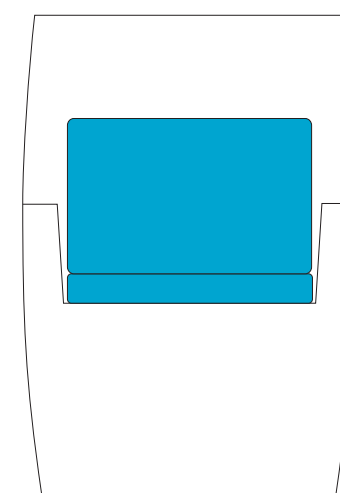
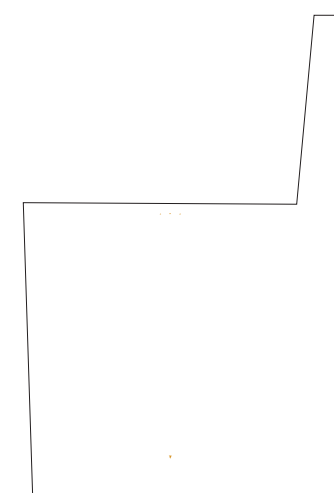

86x67X110cm

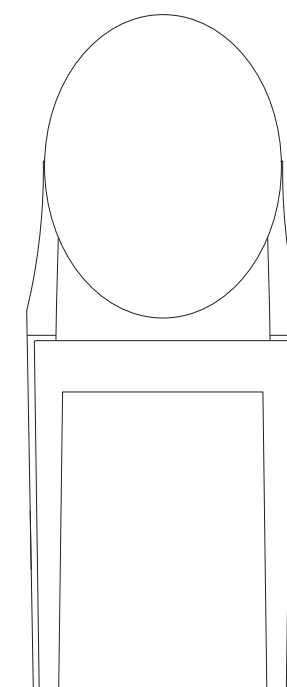

# Terreiro do Paço



